

SHIMANO

BAITRUNNER

BTR-6500B

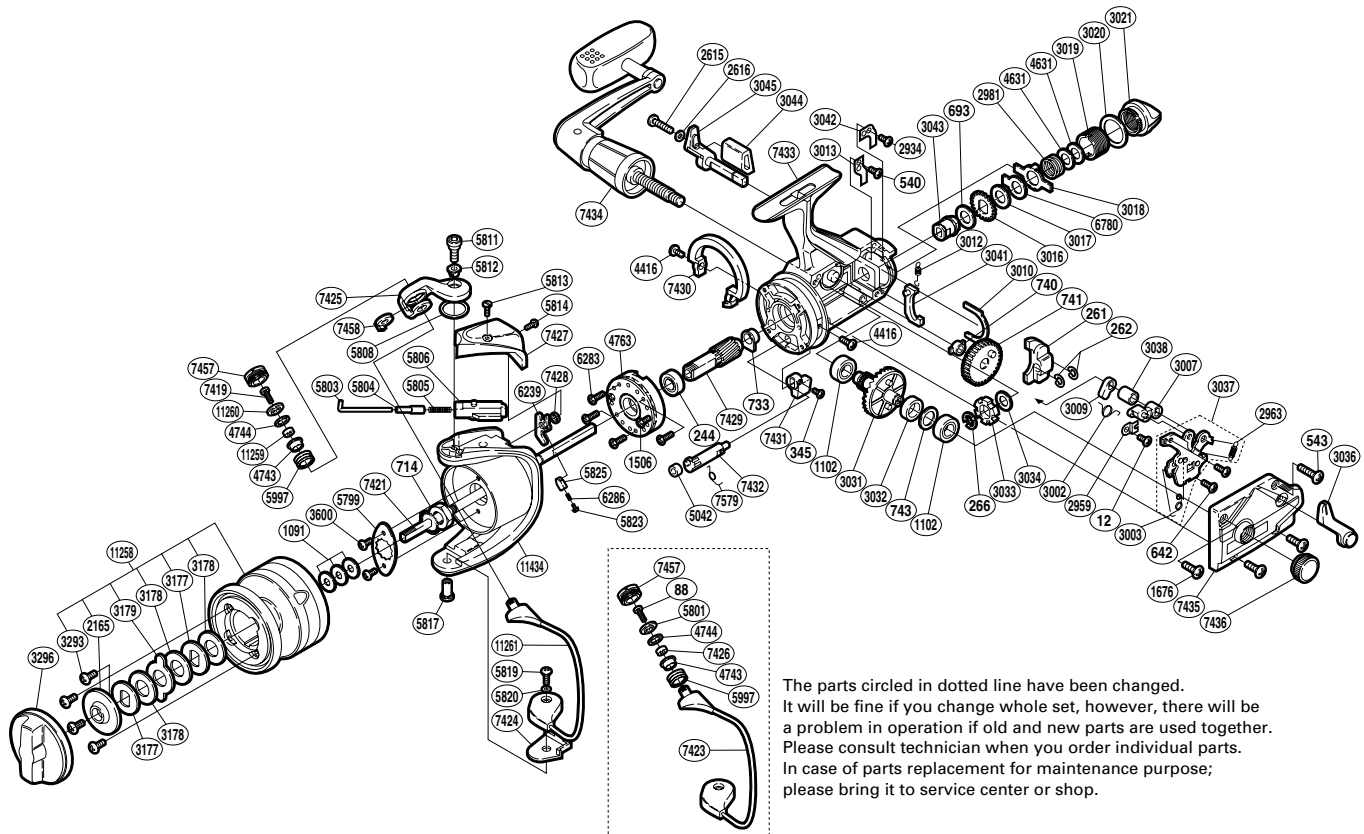

(1SD996501U)

| Part No. | Description | Part No. | Description | Part No. | Description |
|----------|-------------------------------|----------|---------------------------|----------|------------------------------------|
| RD 0012 | Shaft Retainer Screw | RD 3020 | Dial Spacer | RD 5819 | Bail Hold Support Screw |
| RD 0244 | Ball Bearing | RD 3021 | BaitRunner Tension Dial | RD 5820 | Spacer |
| RD 0261 | Oscillating Slider | RD 3031 | Drive Gear | RD 5823 | Lever Spring Guide (A) |
| RD 0262 | "C" Lock | RD 3032 | Drive Gear Spacer | RD 5825 | Lever Spring Guide (B) |
| RD 0266 | "C" Lock | RD 3033 | BaitRunner Ratchet | RD 5997 | Line Roller |
| RD 0345 | Anti-Reverse Lever Screw | RD 3034 | Ratchet Spacer | RD 6239 | Bail Trip Lever |
| RD 0540 | Pawl Guide Screw | RD 3036 | BaitRunner Lever Arm (L) | RD 6283 | Roller Clutch Screw |
| RD 0543 | Side Cover Screw (B) | RD 3037 | Clutch Plate Assembly | RD 6286 | Bail Trip Lever Spring |
| RD 0642 | Clutch Plate Screw | RD 3038 | Clutch Cam Spacer (A) | RD 6780 | Single Eared Washer |
| RD 0693 | Free Spool Tension Washer (A) | RD 3041 | BaitRunner Pawl | RD 7419 | Line Roller Screw |
| RD 0714 | Rotor Nut | RD 3042 | Dial Click | RD 7421 | Main Shaft |
| RD 0733 | Pinion Gear Bushing | RD 3043 | Free Spool Tension Shaft | RD 7424 | Bail Hold Support Spacer |
| RD 0740 | Oscillating Gear Bushing | RD 3044 | BaitRunner Lever Bridge | RD 7425 | Bail Arm |
| RD 0741 | Oscillating Gear | RD 3045 | BaitRunner Lever Arm (R) | RD 7427 | Bail Spring Cover |
| RD 0743 | Washer | RD 3177 | Key Washer | RD 7428 | Bail Trip Lever Washer |
| RD 1091 | Spool Washer | RD 3178 | Drag Washer | RD 7429 | Pinion Gear |
| RD 1102 | Ball Bearing | RD 3179 | Eared Washer | RD 7430 | Friction Ring |
| RD 1506 | Roller Clutch Cover Screw | RD 3293 | Seal Plate Screw | RD 7431 | Anti-Reverse Lever |
| RD 1676 | Side Cover Screw (A) | RD 3296 | Drag Knob | RD 7432 | Anti-Reverse Cam |
| RD 2165 | Seal Plate | RD 3600 | Nut Lock Screw | RD 7433 | Body |
| RD 2615 | BaitRunner Lever Screw | RD 4416 | Friction Ring Screw | RD 7434 | Handle Assembly |
| RD 2616 | Lock Washer | RD 4631 | Tension Spring Washer "B" | RD 7435 | Side Cover |
| RD 2934 | Dial Click Screw | RD 4743 | Line Roller Bushing | RD 7436 | Handle Screw Cap |
| RD 2959 | Lever Shaft Retainer | RD 4744 | Roller Bearing Seal | RD 7457 | Line Roller Screw Cap |
| RD 2963 | BaitRunner Click Spring | RD 4763 | Roller Clutch Assembly | RD 7458 | Line Roller Support Collar |
| RD 2981 | Free Spool Tension Spring | RD 5042 | Anti-Reverse Cam Ring | RD 7579 | Anti-Reverse Cam Spring |
| RD 3002 | Clutch Spring | RD 5799 | Rotor Nut Retainer | RD11258 | Spool Assembly |
| RD 3003 | Clutch Pawl Spring | RD 5803 | Bail Spring Guide (A) | RD11259 | Line Roller Collar |
| RD 3007 | Clutch Arm | RD 5804 | Spring Guide (A) Support | RD11260 | Line Roller Washer |
| RD 3009 | Clutch Cam | RD 5805 | Bail Spring | RD11261 | Bail Assembly |
| RD 3010 | Dial Retainer | RD 5806 | Bail Spring Guide (B) | RD11434 | Rotor |
| RD 3012 | BaitRunner Pawl Spring | RD 5808 | Bail Arm Washer | | |
| RD 3013 | BaitRunner Pawl Guide | RD 5811 | Bail Arm Screw | | |
| RD 3016 | Click Gear | RD 5812 | Bail Arm Screw Collar | RD 0088 | Line Roller Screw (before change) |
| RD 3017 | Free Spool Tension Washer (B) | RD 5813 | Guard Screw (A) | RD 5801 | Line Roller Washer (before change) |
| RD 3018 | Eared Washer "Bfs" | RD 5814 | Guard Screw (B) | RD 7423 | Bail Assembly (before change) |
| RD 3019 | Free Spool Tension Screw | RD 5817 | Bail Hold Support Shaft | RD 7426 | Line Roller Collar (before change) |

(190315)